

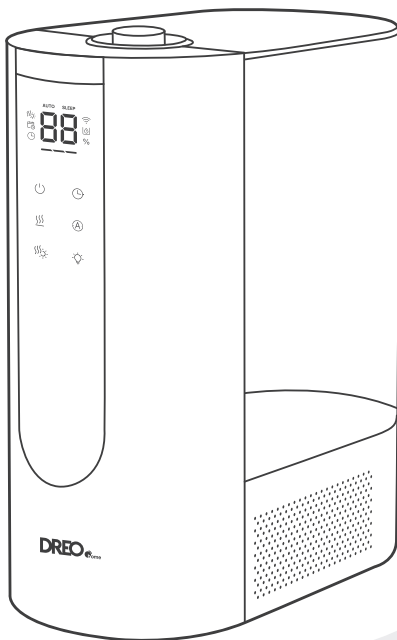

Humidifier  
Humidificateur  
HM813S

USER MANUAL  
MANUEL D'UTILISATION



”

# Thanks for Choosing **DREO!**

Your support means the world to us.  
We hope you enjoy our product as much as  
we did creating it.

# CONTENTS

## 01

IMPORTANT SAFETY  
INSTRUCTIONS

1-2

---

## 02

KNOWING YOUR HUMIDIFIER

3-6

---

## 03

CONNECTING TO YOUR  
APPLIANCE

7

---

## 04

USING YOUR APPLIANCE

8-9

---

## 05

CLEANING AND  
MAINTENANCE

10-15

---

## 06

TROUBLESHOOTING

16-17

---

## 07

DREO CUSTOMER  
CARE

37-38

---

# IMPORTANT SAFETY INSTRUCTIONS

# 01



## **DANGER**

READ ALL CAUTIONARY MARKINGS ON THE APPLIANCE AND SAFETY INSTRUCTIONS IN THE USER MANUAL BEFORE USE AND SAVE THESE INSTRUCTIONS.



**DO NOT** block or cover the nozzle while in operation



**DO NOT** touch or hold the mains plug with wet hands.



**DO NOT** let children or pets play with this appliance.

## **General Safety**

1. Children shall not play with the appliance. Cleaning and maintenance shall not be performed by children without supervision.
2. Use the appliance as described in the user manual only. Any other use not recommended in the user manual may cause fire, electrical shock, or personal injury.
3. This appliance is not intended for use by persons (including children) with reduced physical, sensory or mental capabilities, or lack of experience and knowledge, unless they have been given supervision or instruction concerning use of the appliance by a person responsible for their safety. Children should be supervised to ensure that they do not play with the appliance.

## **Operation Safety**

1. Always place this appliance on a firm, flat and level surface to avoid dropping or tilt.
2. Always place this appliance 2 feet (60 cm) above the floor, 12 inches (30 cm) away from the wall or wooden furniture.
3. **DO NOT** move this appliance while it is on.
4. **DO NOT** attempt to repair any parts on this appliance. Doing so will void your warranty. The inside of this appliance contains no user serviceable parts. All servicing should be performed by qualified personnel only.
5. Never leave water in the reservoir when the appliance is not in use.
6. Do not permit the area around the humidifier to become damp or wet. If dampness occurs, turn the output of the humidifier down. If the humidifier output volume cannot be turned down, use the humidifier intermittently. Do not allow absorbent materials, such as carpeting, curtains, drapes, or tablecloths, to become damp.

7. Do not immerse in water and any other liquids.
8. Do not use the appliance until the base is installed.
9. Do not insert your fingers, pencil and any other objects into the grilles while in operation.
10. **Warning:** Micro-organisms that may be present in the water or in the environment where the appliance is used or stored, can grow in the water reservoir and be blown in the air causing very serious health risks when the water is not renewed and the tank is not cleaned properly every 3 days.
11. **CAUTION:** Mist may be hot in warm mist mode. Do not place your bare hands, face, or other exposed skin over the nozzles while using warm mist.

## Electricity Safety

1. Make sure that the voltage of your electricity supply is the same as that indicated on the appliance.
2. Always unplug before cleaning or leaving the appliance unused for a long period of time. Keep your hands dry when plugging/unplugging.
3. To avoid fire hazard, NEVER put the cord under rugs, near heat registers, radiator, stoves or heaters.
4. Do not use this appliance if the cord has been damaged to avoid fire or electric hazard.
5. Keep the cord out of heavy traffic areas and where it will not be tripped over.
6. Do not operate any humidifier with a damaged cord or plug. Discard the appliance or return to an authorized service facility for examination and/or repair.
7. Do not run cord under carpeting. Do not cover cord with throw rugs, runners, or similar coverings. Do not route cord under furniture or appliances.
8. This appliance has a polarized plug (one blade is wider than the other). To reduce the risk of electric shock, this plug is intended to fit in a polarized outlet only one way. If the plug does not fit fully in the outlet, reverse the plug. If it still does not fit, contact a qualified electrician. Do not attempt to defeat this safety feature.
9. **WARNING:** To reduce the risk of fire or electric shock, do not use this humidifier with any solid-state speed control device.

# FOR HOUSEHOLD USE ONLY

## Gentle Reminder



Check the appliance regularly and refer to TROUBLESHOOTING or contact our customer support if it shows any of the following signs:

- Power cord or plug is damaged.
- Loud noise, unusual smell or excessive heat.

## Specifications

Model No.	DR-HHM013S
Input	AC 120V 60Hz
Rated Power	26W(Cool) 300W (Warm)
Water Tank Capacity	1.6 Gal (6L)

# KNOWING YOUR APPLIANCE

# 02

## Package Contents

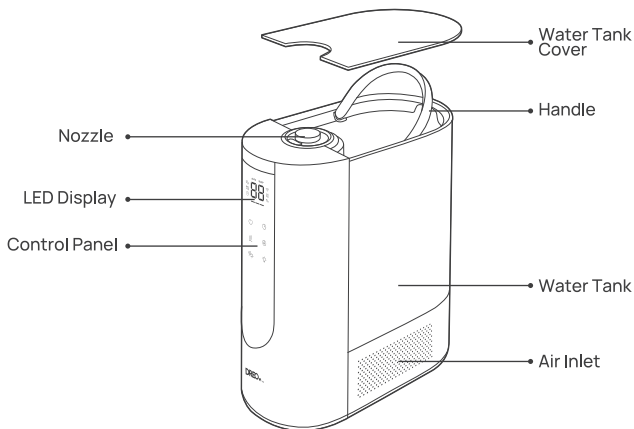

### Top

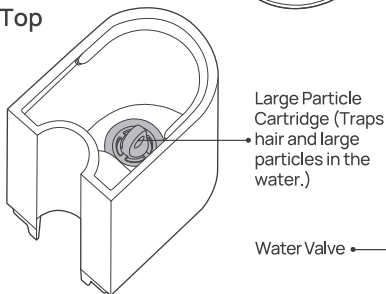

Large Particle Cartridge (Traps hair and large particles in the water.)

Water Valve

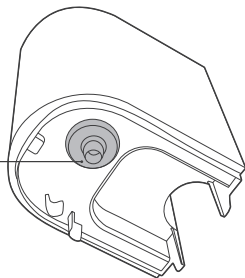

### Bottom

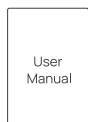
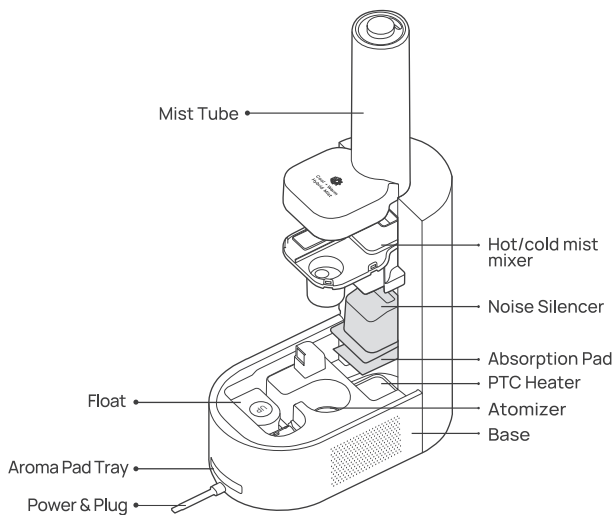

User Manual

User Manual



Cleaning Brush



Quick Start Guide

Quick Start Guide



Aroma Pad



Absorption Pad

## LED Display

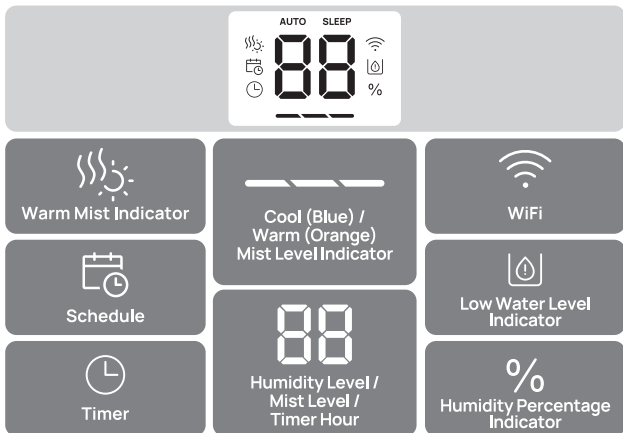

### Note:

- When humidity levels are below 10%, the display will show "LO".
- When humidity levels are above 90%, the display will show "HI".
- When the water is low, the Low Water Level Indicator will flash for 5 seconds, then the humidifier will switch to standby.
- When receiving Software upgrades, the display will show "UP", and the humidifier can't be operated until the upgrade ends.
- You can activate/deactivate Sleep Mode through the DREO app.

## Control Panel

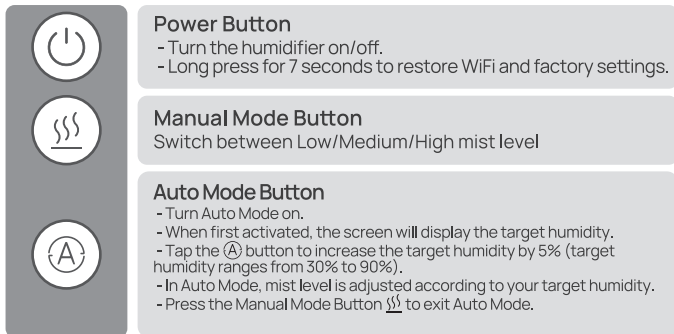





### Warm Mist Button

Turn warm mist off/on

Note: The warm mist is turned on by default.





### Humidity Indicator Light

- Turn the humidity indicator light on/off.
- You can turn off the beep sounds using the humidity indicator light button or through the DREO app.
- Long press for 5 seconds to start cartridge life countdown.
- You can check the cartridge life percentage through the DREO app.



### Timer / WiFi Settings

- Select to set a timer (0-12h)
- Long press for 5 seconds to enter WiFi settings.

**Note:** Long press  and  for 5 seconds to turn off/on WiFi connection and enter/exit Low Power Standby Mode.

## Humidity Indicator Light

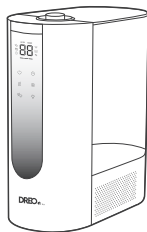

Light Color	Humidity Level
Yellow	$\leq 30\%$
Green	31% - 60%
Blue	$\geq 61\%$

The indicator light will change according to your room humidity level.

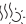
Warm Mist	
Touch  to turn on/off warm mist	
Mist Level	Mist Temperature ( $\pm 3^{\circ}\text{C}$ )
Low	45°C
Medium	50°C
High	55°C

## CAUTION:

Mist may be hot in warm mist mode. Do not place your bare hands, face, or other exposed skin over the nozzles while using warm mist.

# CONNECTING TO YOUR APPLIANCE

# 03



Before connecting the appliance to your mobile device, please scan the QR code on the left or go to the app store and search “DREO”, then select and download the app.



Look for “HM813S” when connecting your new appliance.



You can use the DREO app to connect your appliance to **Amazon Alexa** or **Google Home**. Please follow the in-app instructions to set up your voice assistant.

NOTE: You must create a DREO account to access voice assistants.

- 1 Launch DREO and sign in or create account by following in-app instructions.
- 2 Enable Bluetooth on your mobile device and plug in your appliance.
- 3 Hold the Timer button (⌚) for 5 seconds to start WiFi connection settings.  
(Tip: The WiFi icon (📶) will keep flashing when pairing.)
- 4 Tap + Add Device and select HM813S.
- 5 Follow in-app instructions to complete WiFi connection.

You're now ready to control the appliance on your app.

(Tip: To restart connection settings, hold the Timer button (⌚) again for 5 seconds)

Long press (⏻) for 7 seconds to unpair WiFi and restore factory settings.

# USING YOUR APPLIANCE

# 04

## Before Use

When using your humidifier for the first time, remove the wraps and follow the steps below.

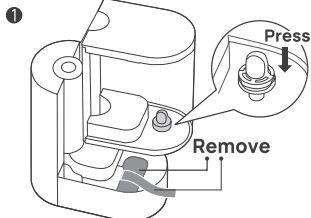

Make sure the cartridge is installed correctly and the label and the cardboard have been removed.

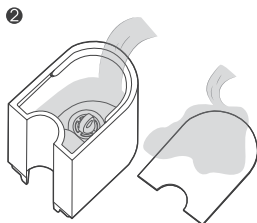

Detach the cover and water tank from the humidifier and clean thoroughly.

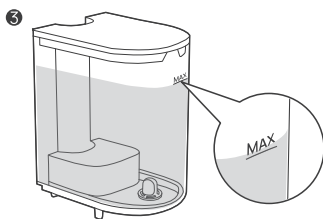

Fill the tank with water, making sure the water doesn't pass the MAX line.

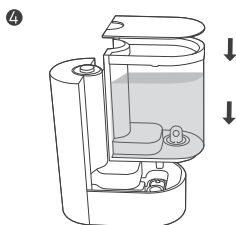

Put the water tank back in place and close the top cover.

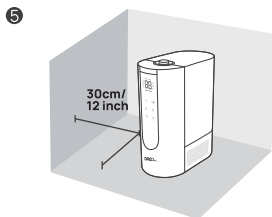

Place the humidifier on a flat, level surface, keeping at least 30 cm/12 inch away from walls or any major obstacles.

### ATTENTION:

- It is recommended to add purified or distilled water to prevent white powder residue from forming.
- Do not add essential oil into the water tank to avoid damage to the tank.
- Do not place the humidifier on the carpet or floor directly.
- Direct the mist away from walls, furniture and electrical appliances.
- It is recommended to place a water-resistant mat under the humidifier to catch spills and droplets.

## Adding Essential Oil

①

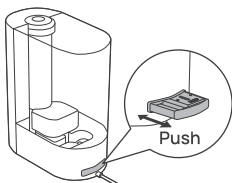

Push to open the aroma pad tray.

②

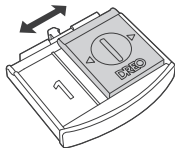

Open the lid on the side you want to add the essential oil.

③

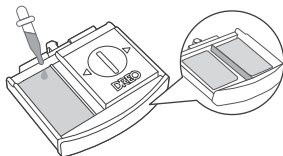

Add 5-10 drops of essential oil on the aroma pad.

④

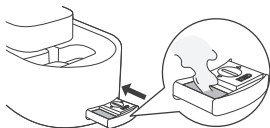

Put the aroma pad tray back in place.

### Note:

- Add essential oils on the aroma pad only. Do not add into the water tank or any other places.
- The scent may be soft, this humidifier is not intended to work as an aroma diffuser.
- The scent level cannot be adjusted.
- The tray contains two separate compartments. Leave open the compartment that has the scent you like.
- If the aroma pad becomes too stiff, it needs to be replaced.

## Adding Essential Oil

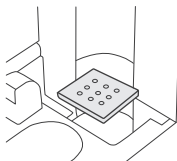

The mineral absorption pads help reduce mineral buildup (scale= inside the humidifier, especially on the heating element).

### Note:

The absorption can be reused after cleaning, but it is recommended to replace it regularly.

# CLEANING AND MAINTENANCE

# 05



- Always turn off and UNPLUG the humidifier before any cleaning or maintenance.
- Do not clean the main body under running water.
- Do not let water splash into the air outlets.
- Do not use any chemical agents when cleaning the humidifier.
- Store in a cool, dry place and cover it to protect from dust.
- Do not overfill the humidifier due to the potential risk of electric shock.

## Filling & Refilling

Empty the tank and refill every third day. Before refilling, clean it with fresh tap water or cleaning agents if required by the manufacturer. Remove any scale, deposits or film that has formed on the sides of the tank or on interior surfaces, and wipe all surfaces dry.

1

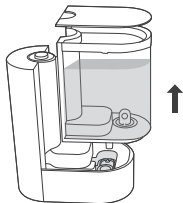

Detach the water tank from the base.

2

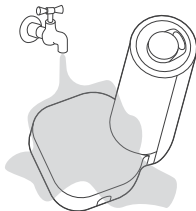

Remove the mist tube and rinse it with warm water.

3

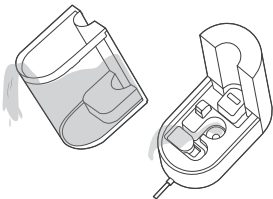

Take out the water tank cover, drain any remaining water from the tank and the base.

**Note:** If you've used the warm mist setting, use with caution in case the water is still hot.

4

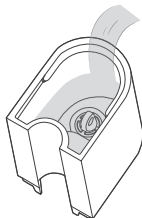

Rinse the tank with warm water.

5

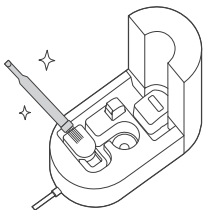

Gently clean the base with a soft cloth or the included cleaning brush.

6



Wipe the tank clean with a soft, damp cloth.

7

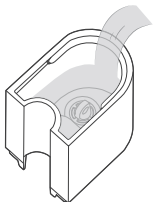

Fill the tank with room temperature water. Do not fill with hot water.

8

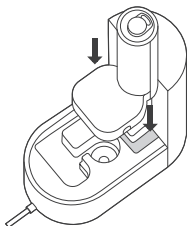

Attach the mist tube to the back of the base.

9

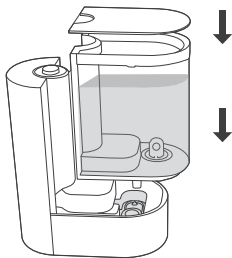

Attach the water tank to the base, replace the top cover.

# Descaling

RECOMMENDED ONCE A MONTH

1

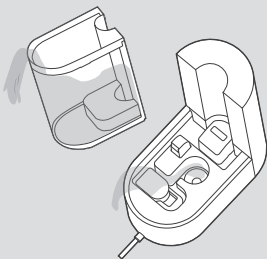

Drain any remaining water from the tank and the base.

2

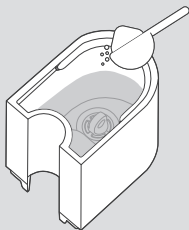

Fill the tank with a solution of bleach and water (one teaspoon of bleach for each gallon of water). Replace the tank cover and shake around the tank.

3



Fill the tank with a solution of bleach and water (one teaspoon of bleach for each gallon of water.). Replace the tank cover and shake around the tank.

4

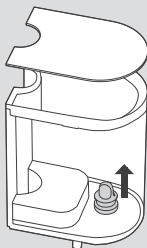

Remove the large particle cartridge.  
**Note:** Do not remove the water valve below the cartridge.

5

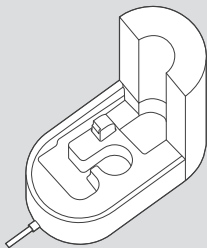

Remove the mist nozzle, mist tube, hot/cold mist mixer, noise silencer and float.

6

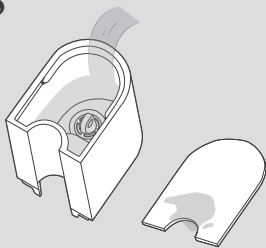

Remove the tank and detach the cover, drain any remaining solution from the tank and the base. Rinse the tank with water until the bleach smell is gone.

7

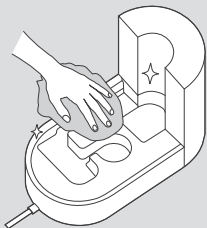

Clean the base with a soft cloth or the included cleaning brush to remove excess of mineral deposits. Make sure all parts are dry before reassembling your humidifier.

## Cleaning the aroma pad tray

RECOMMENDED ONCE A WEEK

1

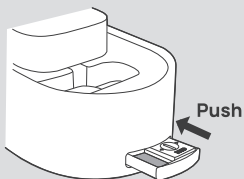

Push to open the aroma pad tray at the back of the base to pull it out.

2

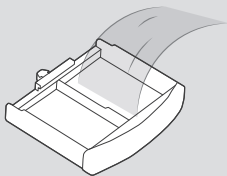

Rinse with water and place back into the base.



## Reassembling

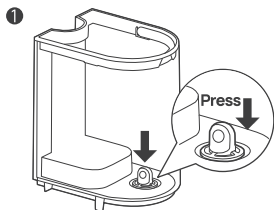

Place the cartridge back into the tank. Make sure the cartridge clicks in place.

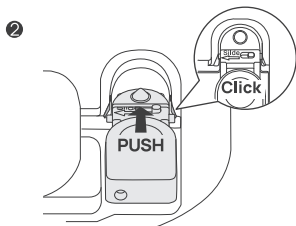

Align the float with the cavities on both sides and push downwards till you hear the "click"

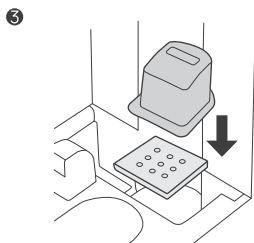

Place the absorption pad and the noise silencer back to the PTC heater.

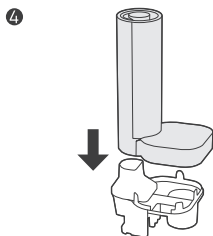

Place the mist tube on top of the hot/cold mist mixer. Make sure the two parts click in place.

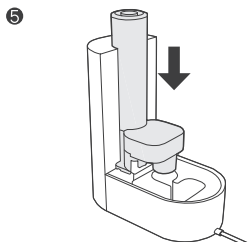

Place the mist tube and the hot/cold mist mixer over the base.

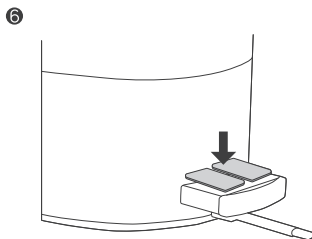

Place the aroma pad back into the aroma box.

## Is Your New Humidifier Leaking?

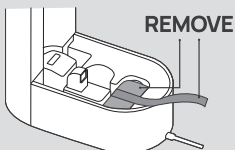

Make sure to remove the label and the cardboard.

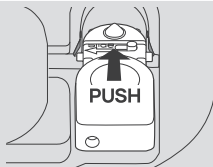

Align the float with the cavities on both sides and push downwards till you hear the "click".

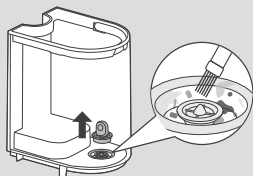

Remove any particles or hair blocking the water valve.

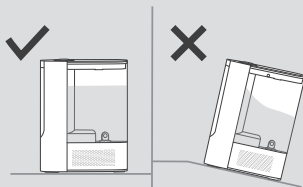

Make sure the humidifier is placed on a flat surface.

## Contact Customer Service If...

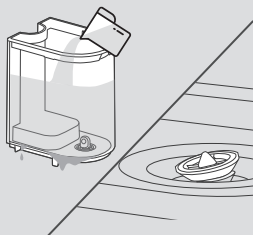

The water valve is not flat or the tank leaks water when refilling.

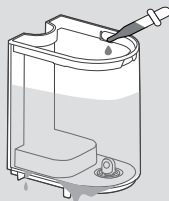

Your water tank has leakage due to prolonged use of essential oils.

If your humidifier keeps leaking water, please contact customer support (see page 38).

## My humidifier does not work.

1. Make sure that the cord is connected to a powered outlet and the mains voltage corresponds with the voltage indicated on the humidifier.
2. The humidifier will shut down automatically in the event of low water.
3. Check the water tank is installed properly.
4. In Auto Mode, the humidifier will stop adding moisture when it reaches the room humidity target.

## My humidifier is not misting.

1. Turn the mist level to a higher setting.
2. The base has too much water. Empty the base and refill the water tank (not the base).
3. Please check whether the air inlet is blocked.
4. Make sure the nozzle is not blocked.
5. Make sure the humidifier is not a flat surface.
6. The water temperature may be too low. Turn the mist level to the highest setting and let it run for a while, then adjust to the desired setting.
7. If the water tank or base have been washed with detergent, rinse thoroughly with clean water to remove any remaining detergent.

## The mist produces an unpleasant smell.

1. Use purified or distilled water only. It is not recommended to use tap water.
2. Change water regularly to avoid dirty water accumulation.
3. Clean the humidifier and keep it dry for 12 hours with the cover detached.
4. Clean the aroma pad tray, change the aroma pad.

## Water leaks from my humidifier.

1. Make sure the silicone sealing ring around the water outlet valve is secure.
2. Avoid running the humidifier in a room with over 60% relative humidity.
3. Wipe any excess water.
4. Do not shake the humidifier.
5. Make sure to place the humidifier on a flat, level surface.
6. Check the water tank for leaks. If there are leaks, contact Customer Support (see page 38).

## Humidifier uses water too quickly.

1. The humidifier uses up water based on the environmental temperature and humidity. If your environment is cold and/or dry, the humidifier will run out of water faster.
2. Using the warm mist function will use up water faster.
3. Switch to Auto Mode to adjust mist level based on your room's humidity.

## White dust appears around the humidifier.

1. It is recommended to purchase the DREO replacement filter that filters out white dust.
2. Using purified or distilled water to fill the humidifier. Avoid using water with high mineral content, such as tap water.
3. Clean the humidifier regularly (see Cleaning & Maintenance, page 10-15).

## Mist is not warm enough after pressing .

1. Press  to adjust the mist temperature from 113°F to 133°F.
2. Allow the humidifier to heat up for about 5-10 minutes to produce warm mist.
3. Clean and descale the heating element (see Cleaning & Maintenance, page 10-15).

## Humidity in the room remains unchanged.

1. Use a higher mist level setting.
2. Depending on your environment, the humidifier may take longer to humidify your air.
3. The room may be larger than the humidifier's effective range. If the room is larger than 215-430 ft<sup>2</sup> / 20-40 m<sup>2</sup>, the humidifier will not be as effective.

If your humidifier keeps leaking water, please contact customer support (see page 38).

www.dreo.com



# LOVEAIR

Bedienungsanleitung heruntergeladen  
von [loveair.de](https://loveair.de)

**Looking for help?**  
**Besoin d'aide avec votre produit?**

Contact us to get expert support.  
Contactez-nous pour obtenir l'aide d'un expert.



ca-support@dreo.com



www.dreo.com